

SNAPUp®

A Family of Dependable Displays

MP1 4x3, Rem 82204
3x3, Rem 82203
2x3, Rem 82202
1x3, Rem 82201

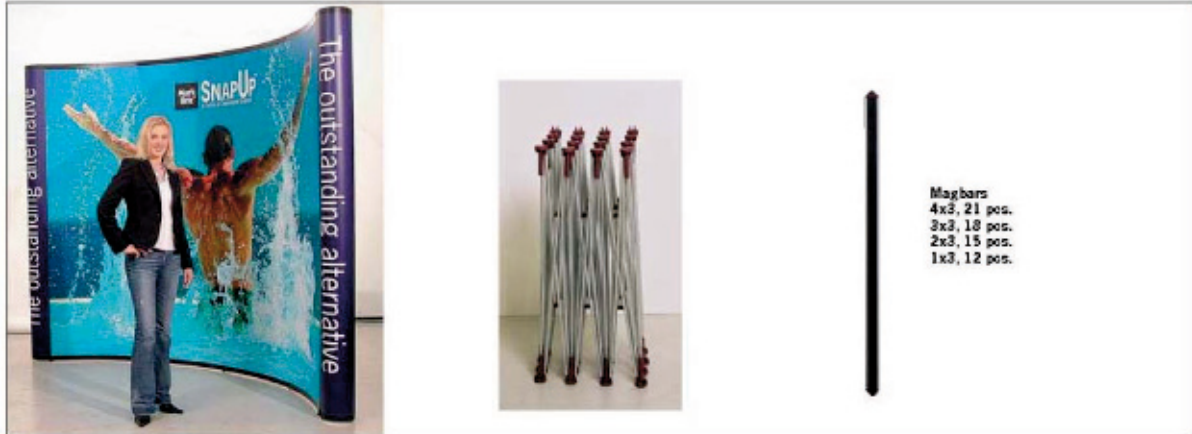

Mounting instruction

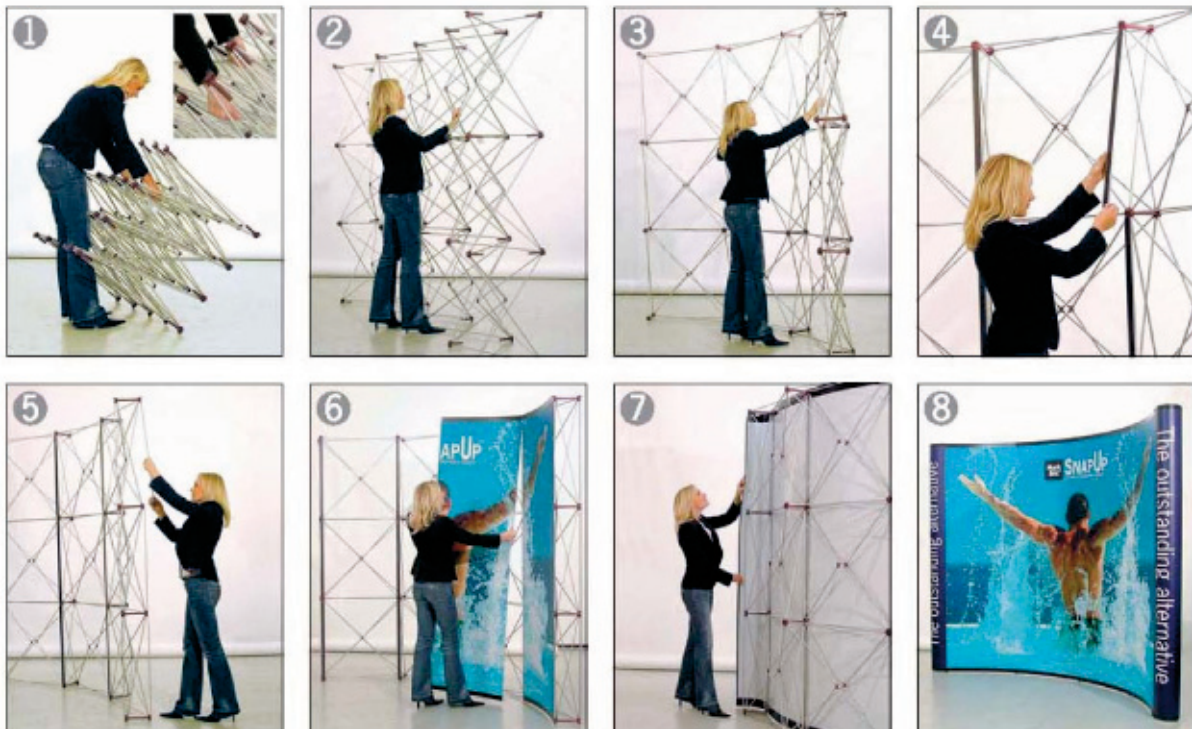

Unmounting



Graphic panel production

Size of graphic panels

The overall SnapUp graphic consists of a number of separate graphic panels as follows:

- Structure 4x3**
4 centre panels + 2 end panels
(for a double sided model add 4 rear panels)
- Structure 3x3**
3 centre panels + 2 end panels
(for a double sided model add 3 rear panels)
- Structure 2x3**
2 centre panels + 2 end panels
(for a double sided model add 2 rear panels)
- Structure 1x3**
1 centre panel + 2 end panels
(for a double sided model add 1 rear panel)

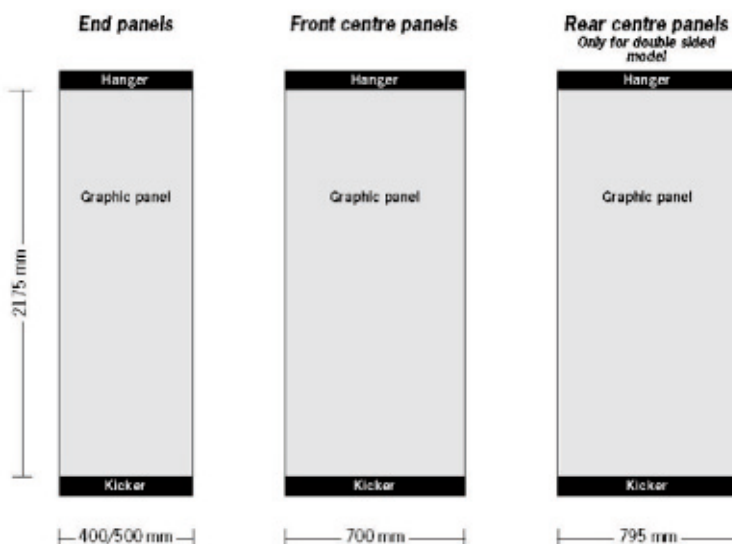

Lamination

The printed graphic panels must be laminated before use.

We recommend the following material:

Front side – Centre and end panels:
150 microns (0,150 mm) "deep crystal"

Reverse side – Centre panels:
220-250 microns (0,220 - 0,250 mm) "stop light"

Reverse side – End panels:
115-125 microns (0,115 - 0,125 mm) "stop light"

We recommend to roll the banner with the printed side out!

Mounting of Kickers and Hangers

Kickers and hangers to be fixed at the bottom and at the top of the graphic panels (reverse side).

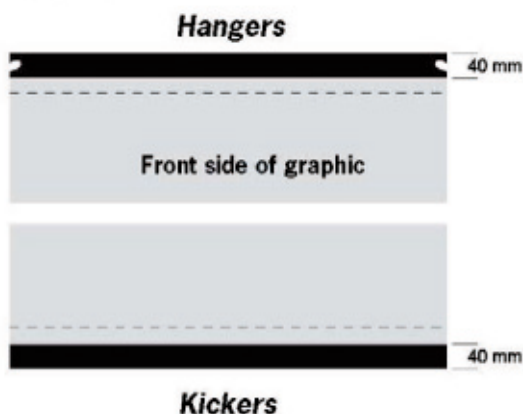

Kickers

Please observe!

Kickers and hangers for the endpanels are thinner.

Application Techniques

To obtain optimum adhesion, the bonding surfaces must be well unified, clean and dry. Typical surface cleaning solvents are isopropyl alcohol/water mixture (rubbing alcohol) or heptane.

Note: Be sure to follow solvent manufacturer's precautions and directions for use when using solvents.

Mounting of Magnetic Tape

Magnetic tape to be fixed vertically along each side of the graphic panels.

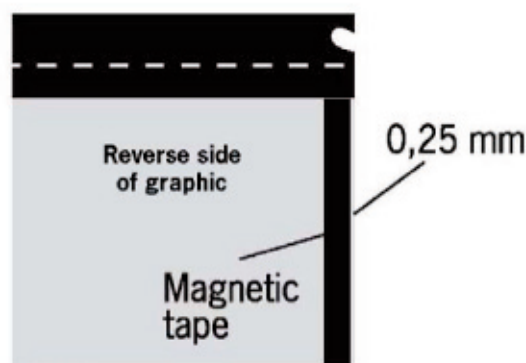

IMPORTANT

Carefully mount the magnetic tape slightly inset from the edge of the graphic panel by **approximately 0,25 mm**. Once mounted, a very thin straight white line should show between the edge of the graphic and the outside edge of the magnetic tape. **Do not exceed 0,5 mm.**